

FTE FULL TROUGH ELEMENT 24.0709

Average Weight: 192g.
Tolerances apply, all dimensions mm.
* Face of reflector - face of element
using 0.75mm reflector, mounting
slot size 15 x 42 mm.

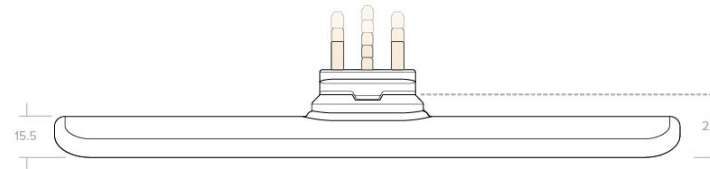

Comes with Wave
Spring and Clip

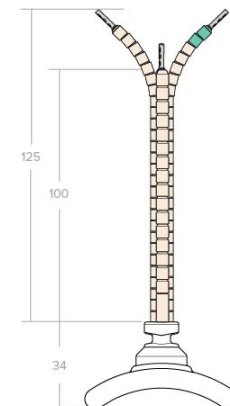
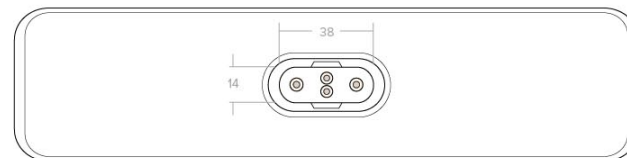
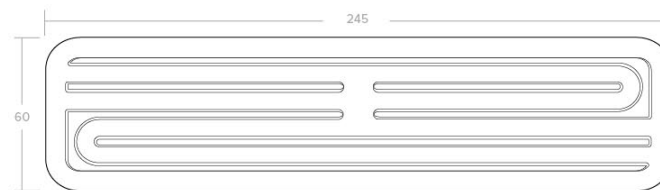

FTE FULL TROUGH ELEMENT 24.0709

Average Weight: 192g.
Tolerances apply, all dimensions mm.
* Face of reflector - face of element
using 0.75mm reflector, mounting
slot size 15 x 42 mm.



Comes with Wave
Spring and Clip

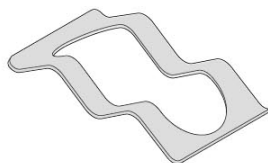
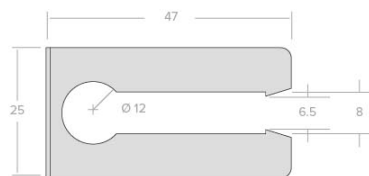
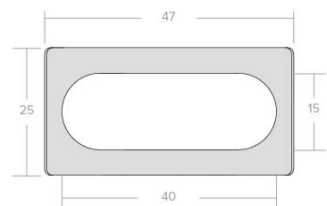

WAVE SPRING

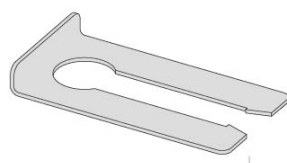

CLIP

WAVE SPRING AND CLIP 20.0709

Tolerances apply, all dimensions mm.

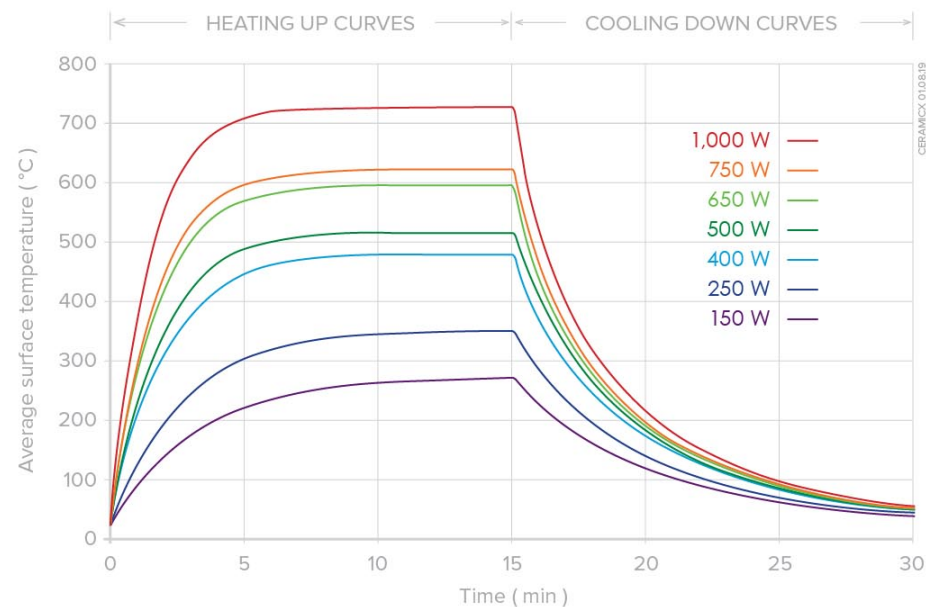

FTE Full Trough Element

Heating up and cooling down curves showing average surface temperature taken with an infrared thermometer set at an emissivity of 0.95 (Element mounted in an aluminised steel reflector RAS)

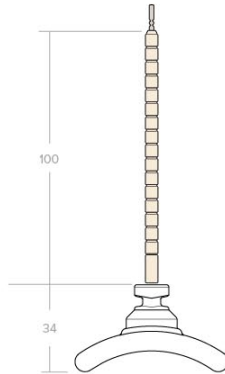
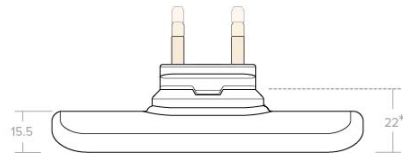
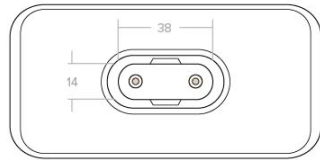
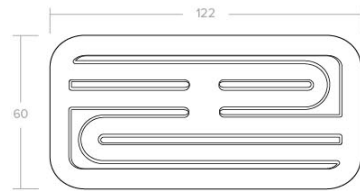

HTE HALF TROUGH ELEMENT 24.0719

Average Weight 105g.
Tolerances apply, all dimensions mm.
* Face of reflector - face of element
using 0.75mm reflector, mounting
slot size 15 x 42 mm.



Comes With Wave
Spring and Clip

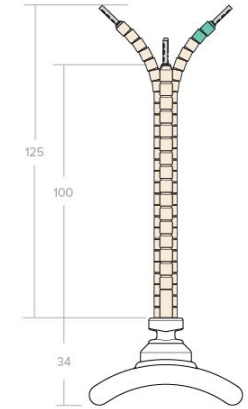
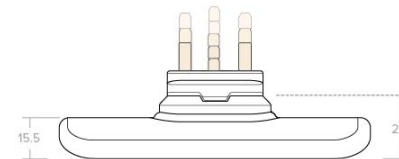
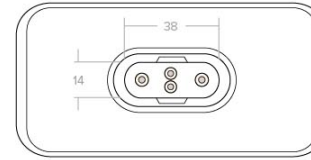
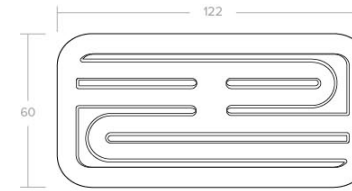

HTE HALF TROUGH ELEMENT 24.0719

Average Weight 105g.
Tolerances apply, all dimensions mm.
* Face of reflector - face of element
using 0.75mm reflector, mounting
slot size 15 x 42 mm.



Comes With Wave
Spring and Clip

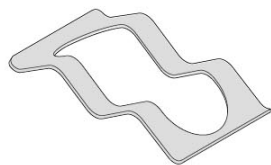
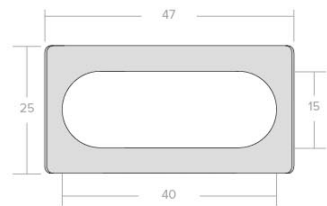

WAVE SPRING

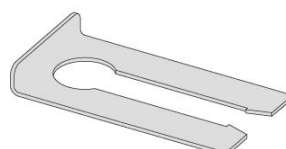
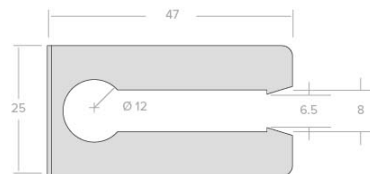

CLIP

WAVE SPRING AND CLIP 30.016

Tolerances apply, all dimensions mm.

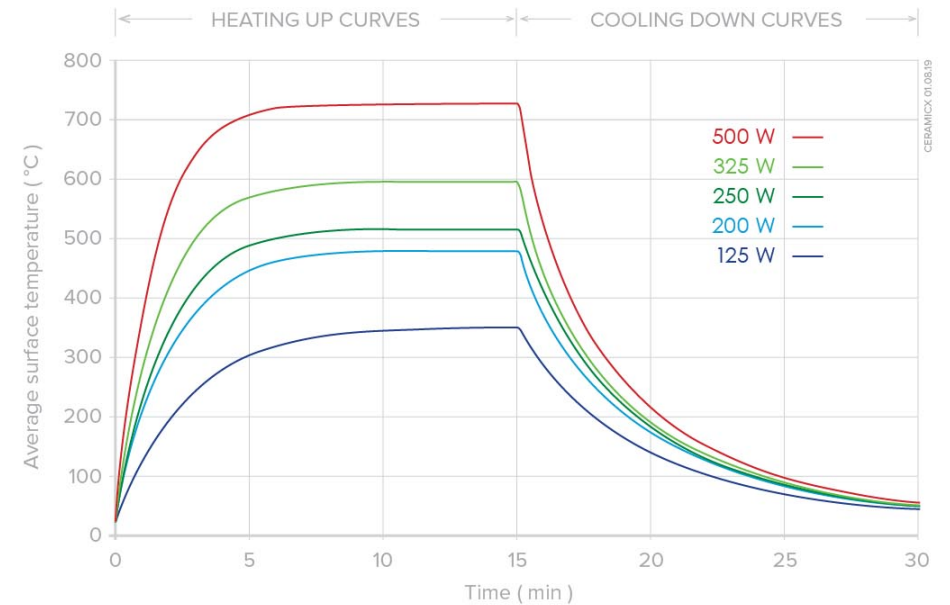

HTE Half Trough Element

Heating up and cooling down curves showing average surface temperature taken with an infrared thermometer set at an emissivity of 0.95 (Element mounted in an aluminised steel reflector RAS)

CERAMICX 01.08.19

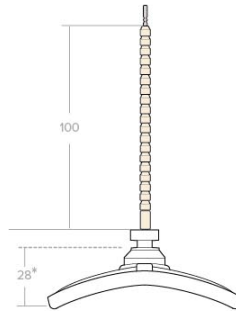
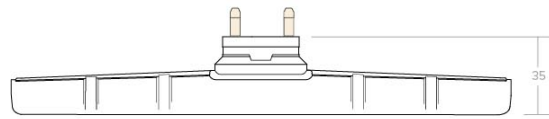
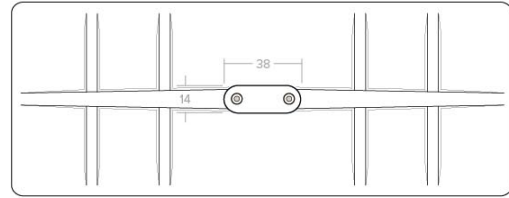
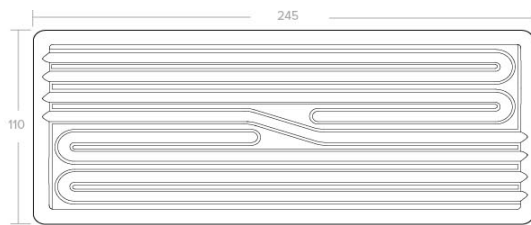

LFTE LARGE FULL TROUGH ELEMENT 245278

Average Weight: 356g.
Tolerances apply, all dimensions mm.
* Face of reflector - face of element
using 0.75mm reflector; mounting
slot size 15 x 42 mm.



Comes with Wave
Spring and Clip

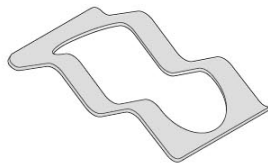
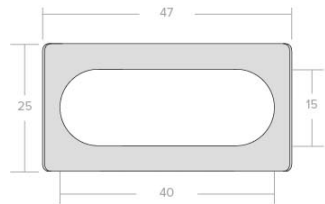

WAVE SPRING

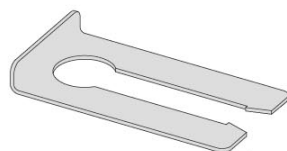
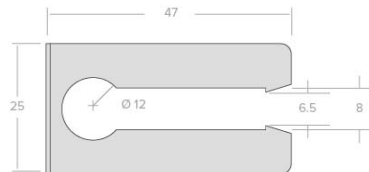

CLIP

WAVE SPRING AND CLIP 245279

Tolerances apply, all dimensions mm.

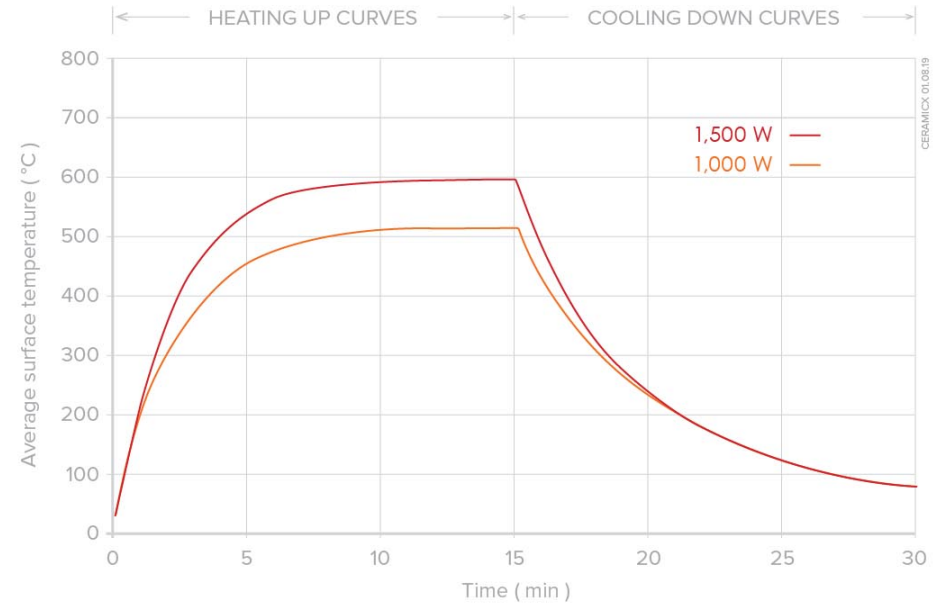

LFTE Large Full Trough Element

Heating up and cooling down curves showing average surface temperature taken with an infrared thermometer set at an emissivity of 0.95 (Element mounted in an aluminised steel reflector RAS)

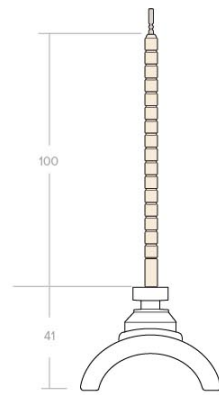
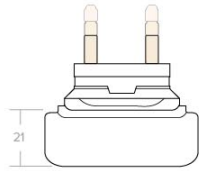
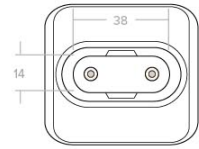
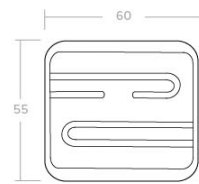

QCE QUARTER CURVED ELEMENT
24.0719
Average Weight: 70g.
Tolerances apply, all dimensions mm.



Comes with Wave Spring and Clip

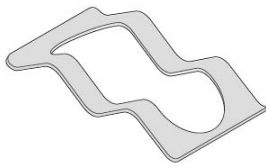
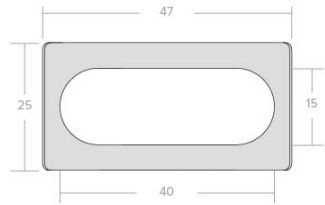

WAVE SPRING

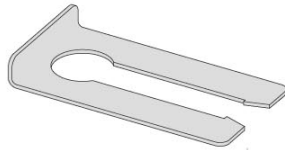
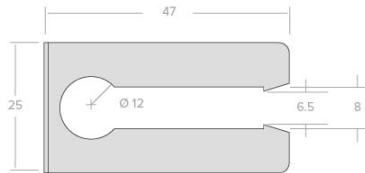

CLIP

WAVE SPRING AND CLIP
24.0719
Tolerances apply, all dimensions mm.

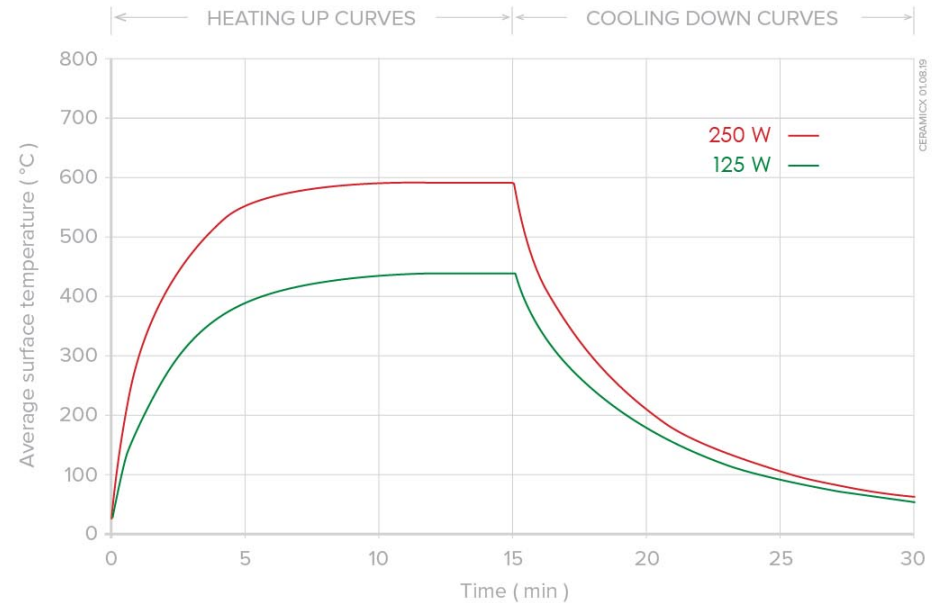

QCE Quarter Curved Element

Heating up and cooling down curves showing average surface temperature taken with an infrared thermometer set at an emissivity of 0.95 (Element mounted in an aluminised steel reflector RAS)

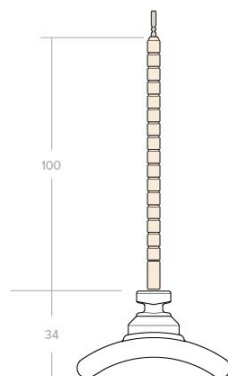
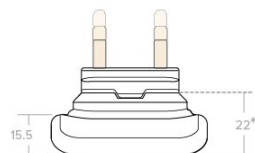
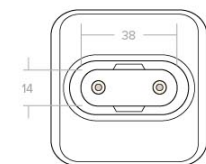
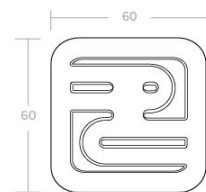

QTE QUARTER TROUGH ELEMENT 24.0759

Average Weight: 65g.
Tolerances apply, all dimensions mm.
* Face of reflector - face of element
using 0.75mm reflector, mounting
slot size 15 x 42 mm.



Comes with Wave
Spring and Clip

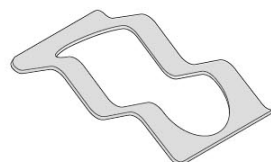
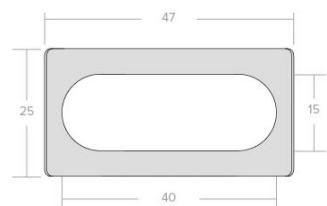

WAVE SPRING

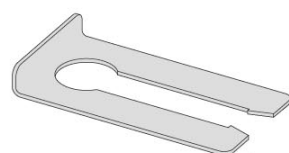
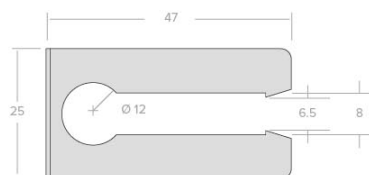

CLIP

WAVE SPRING AND CLIP
24.0759
Tolerances apply, all dimensions mm.

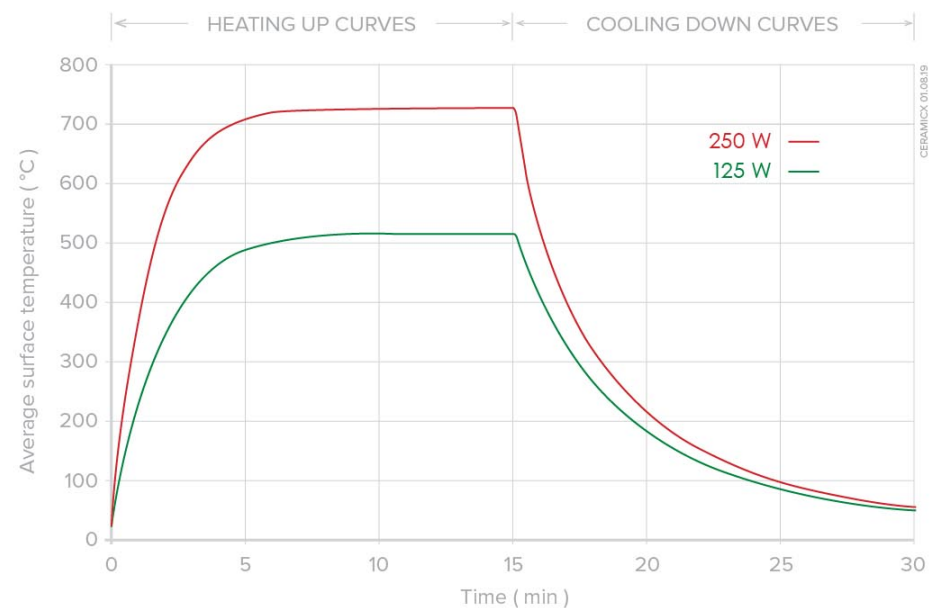

QTE Quarter Trough Element

Heating up and cooling down curves showing average surface temperature taken with an infrared thermometer set at an emissivity of 0.95 (Element mounted in an aluminised steel reflector RAS)